

Remote Control Panel (Zone selection and level)

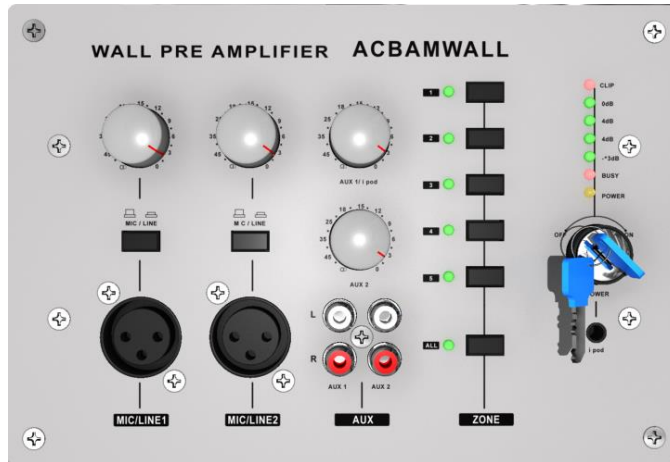

Description

- 2 switchable XLR Mic/Line inputs (to connect e.g. a microphone).
- 2 auxiliary inputs, to accommodate an external audio source (e.g. iPod, PC, tablet...)
- 1 pod input – 1 channel.
- On / Off by key switch.
- This panel only works with a 5-zone card (Article Number ACBAMC5Z) interface module between ACBWALL5Z and ATT Zone amplifier ACBAM120RJ, ACBAM240RJ & ACBAM480.
- 5-Zone selector, to distribute the signal on one or five areas.
- Panel dimensions allow an easy integration in a wall.

Electrical characteristics

Micro / Line input level :	MIC : -50 dBu (2.45 Mv : 600 ohm Bal.) LINE : -10 dBu (245 Mv : 10 KOhm)
Output level :	0 dBu (V.R max.)
Signal to noise ratio :	Mic : more than 65 dB / I pod : more than 75 dB
Frequency response :	20 Hz / 20 kHz
THD :	0.1 %
Consumption :	4.8 W
Power inner / extra :	17V / 24V
Material :	Iron
Dimensions :	220 / 148 / 58 mm
Net weight:	1.30 kg

P/N : ACBWALL5Z

Remote Control Panel (Zone selection and level)

Installation diagram

ACBWALL5Z



ACBAM5Z



ACBAM5Z



ACBAM120RJ, 240RJ, 480

Dimensional

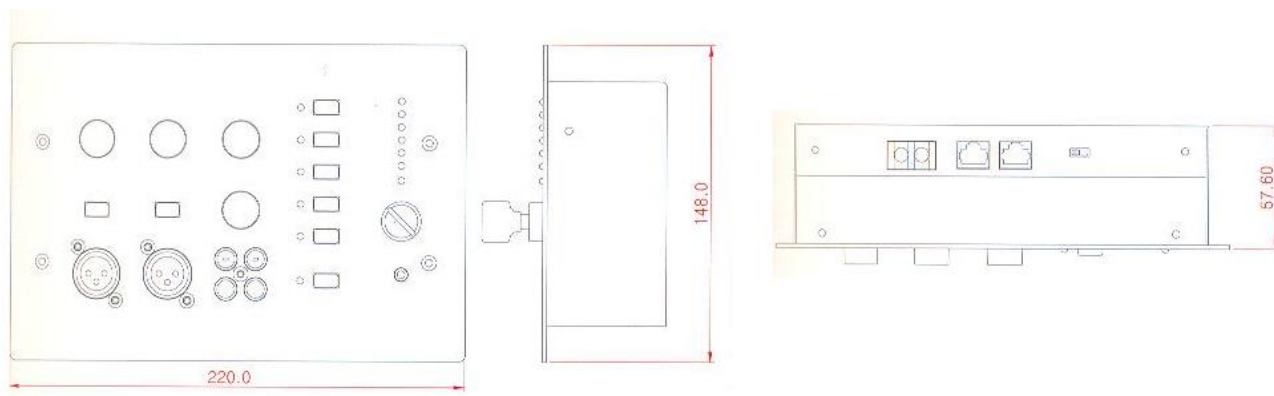

Ordering information

Part nb	Designation	Packaging
ACBWALL5Z	Remote control panel	Unit